

# 1 Choose a Location

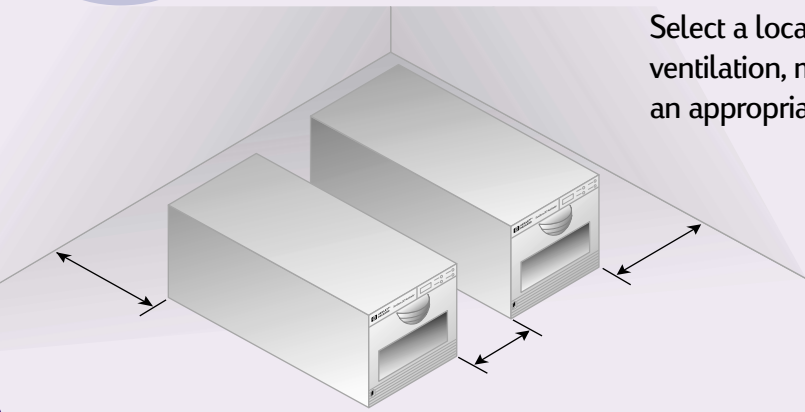

Select a location that has adequate clearance for ventilation, minimal particulate contamination, and has an appropriate power source.

If you are going to install your unit into a rack, refer to the rack instructions on this poster or chapter 1 of the User's Guide.

# 3 Connect the Autoloader

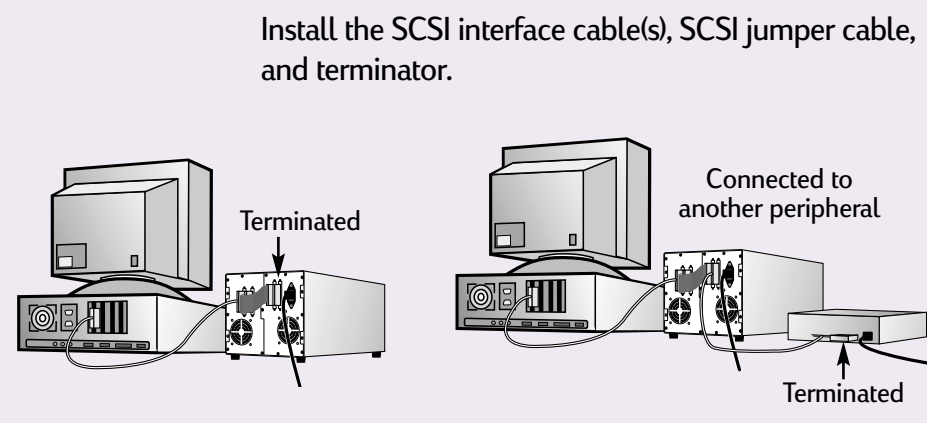
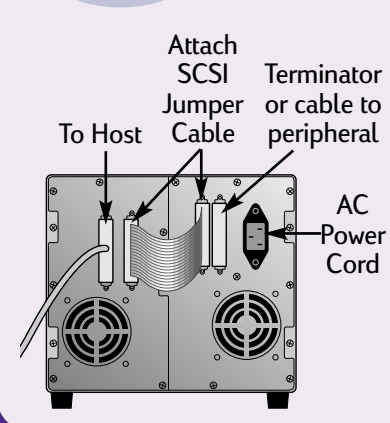

Install the SCSI interface cable(s), SCSI jumper cable, and terminator.

# 5 Verify Installation



Install the TapeAssure utility from the HP SureStore Tape CD onto your host computer to ensure your host can talk to the Autoloader and to the drive.

# 1 Mount Clipnuts

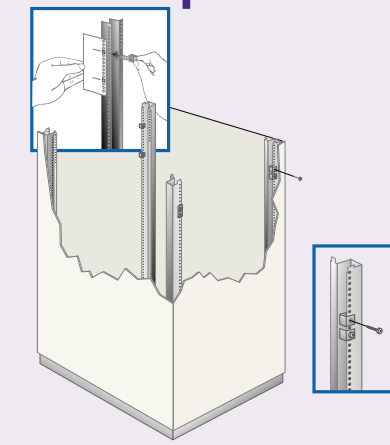

Using the paper template as a guide, insert the clipnuts where you want to place the Autoloader.

- A. Install two clipnuts into each front rail of the rack. To ensure a level shelf, count the holes between each clipnut so that they are in the same position for each rail.
- B. Install two clipnuts with one hole open between them on the back rail.
- C. Loosely install six 10-32 screws in the four clipnuts on the front rails and the two bottom clipnuts on the back rails.

# 3 Insert Filler Panel

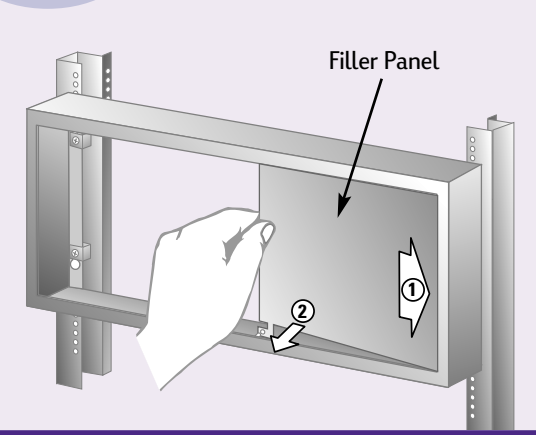

Insert the filler panel tab into the slot on the bezel opposite the Autoloader side. Snap the filler panel onto the bezel.

If installing two Autoloaders, do not insert the filler panel. After inserting the shelf, remove the cosmetic covers and slide the Autoloaders in side-by-side.

# 5 Remove Feet and Cover

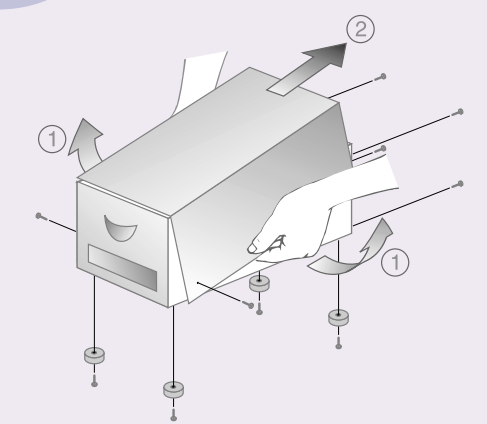

Remove the four screws on the back and two screws on the side of the Autoloader. Remove the cosmetic cover by gently pulling the sides out and then lifting. Unscrew and remove the feet from the Autoloader.

# 2 Attach the Bezel

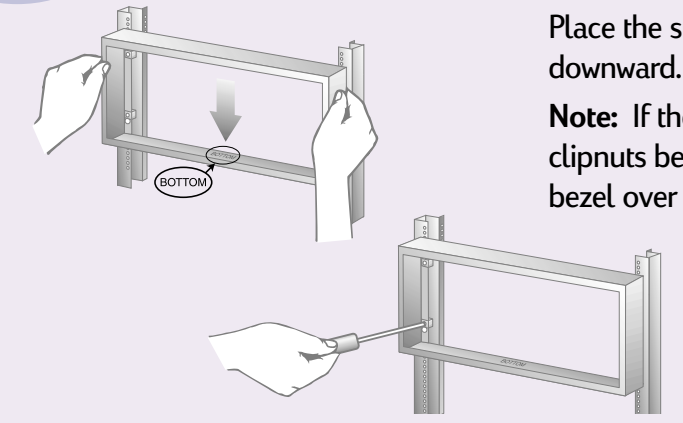

Place the support bezel over the front clipnuts and slide downward. Tighten the four screws in the clipnuts.

**Note:** If there is no room to slide the bezel over the clipnuts because of other products located above, hold the bezel over the clipnuts, then install and tighten screws.

# 4 Install the Shelf

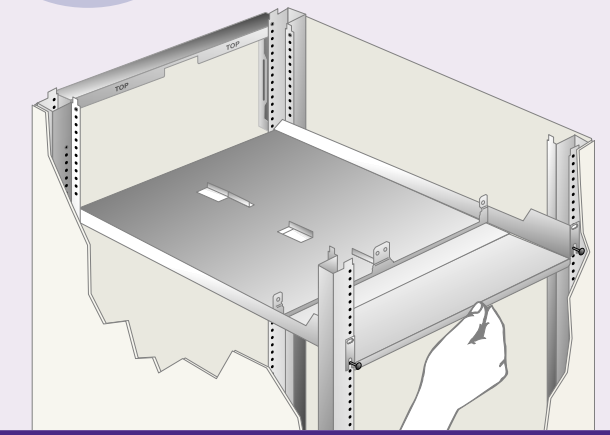

From the back, slide the shelf into the rack until the front lip is over the bezel. Slide the rear lip over the clipnuts on the back rails. Tighten the screws in the bottom clipnuts. Install and tighten two 10-32 screws in the top clipnuts.

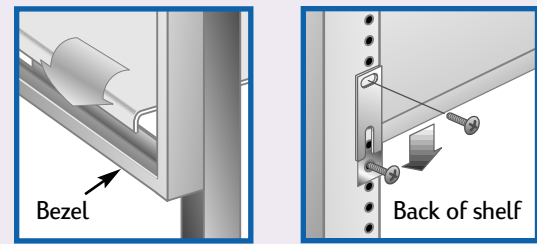

# 6 Install the Autoloader Unit

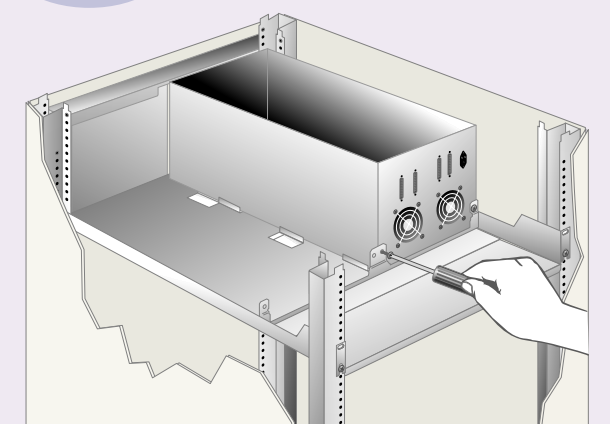

From the front, slide the Autoloader onto the shelf until it rests firmly against the support bracket. Install two M4x10 screws through the support bracket into the back of the unit to secure it.

## 2 Install the SCSI Bus Adapter

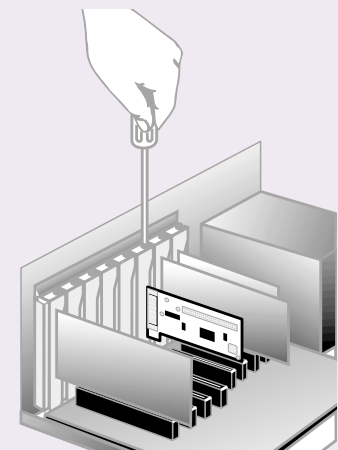

Refer to the Adapter User's Guides for installation procedures.

**NOTE:** Power down the host before installation.

## 4 Power on the Autoloader

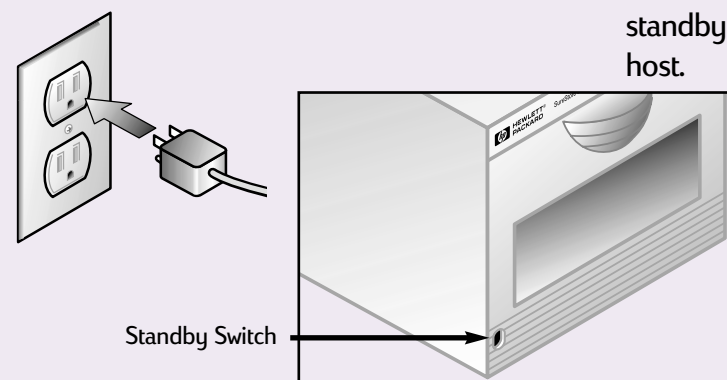

Connect the power cord into a grounded outlet. Press the standby switch. Power on other peripherals and then the host.

**NOTE:** Damage will not occur by plugging the Autoloader into a power source while the standby switch is on.

## 6 Configure the Backup Software

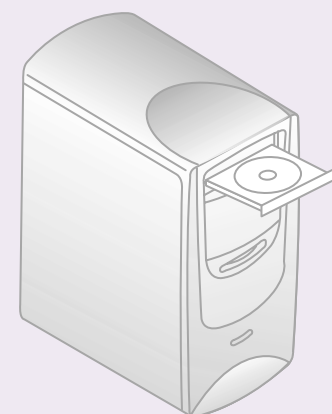

Follow the instructions provided with your backup software to configure it to your Autoloader. Several trial versions are provided with the product for your evaluation.

### For More Information...

**Support and Product Information:** [www.hp.com/go/automated](http://www.hp.com/go/automated)  
Click on *Technical Support* to enter the *Customer Care website*.

Refer to the HP SureStore Tape Installation CD for translations of this information.  
Eine Übersetzung dieser Informationen befindet sich auf der HP SureStore Tape Installations-CD.  
Reportez-vous au CD-ROM d'installation HP SureStore Tape pour la traduction de ces informations.  
En el CD de instalación de la cinta HP SureStore Tape encontrará traducciones de esta información.  
Nel CD di installazione di HP SureStore Tape sono disponibili le versioni in più lingue di queste informazioni.  
Raadpleeg de CD-ROM met installatie-instructies voor vertaling van deze informatie.  
この情報の各国語への翻訳は、HP SureStore Tape Installation CD を参照してください。  
此資訊的翻譯對照，參看 HP SureStore Tape Installation CD (HP SureStore 磁帶安裝 CD)。  
要获得该信息的译文，请参阅 HP SureStore Tape 安装 CD。  
이 정보의 번역판은 HP SureStore Tape Installation CD를 참조하십시오.

### Loading the Magazine into the Autoloader

With the handle facing out of the Autoloader, insert the magazine into the Autoloader. Slide in until the magazine "clicks" into place. Rotate the handle all the way to the left to store.

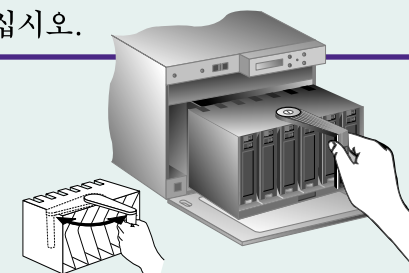

### Loading Tapes into the Internal Slots

To load internal tapes, remove the magazine from the Autoloader. With the tape's write-protect switch facing out of the Autoloader and the smooth edge facing the top of the slot, insert the tape until it "clicks" into place.

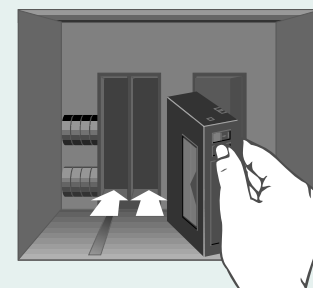

### Loading Tapes into the Magazine

With the tape's write-protect switch facing out and the smooth edge facing the top of the magazine, insert the tape until it "clicks." A metal tab will extend to lock it into place.

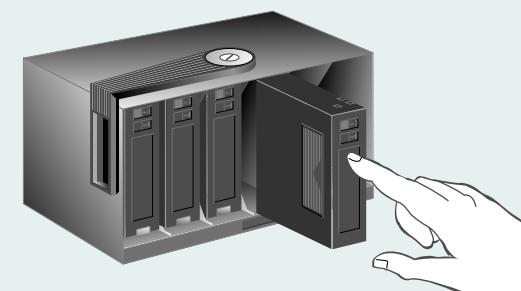

### Autoloader Accessories and Supplies:

#### Removable Magazines

Move and store tape cartridges easily with extra removable magazines.

With 6 DLT tape cartridges,  
(Part No. C6289J)

Without 6 DLT tape cartridges,  
(Part No. C6288J)



#### Rack Mount Kit

Maximize storage space by mounting up to two Autoloaders side-by-side in an HP recommended 48.3 cm (19 inch) rack.  
(Part No. C6287J for HP racks)  
(Part No. C6287L for Non-HP racks)

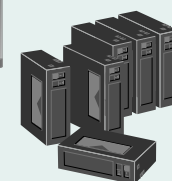

Data subject to change  
©1999 Hewlett-Packard Company  
Printed in USA 9/99  
Part Number C6282-90017



### Check Your Accessory Kit Contents

**SCSI Jumper Cable:** Connects the drive to the Autoloader on one bus for a standard configuration. See Chapter 1 of the User's Guide for more information.

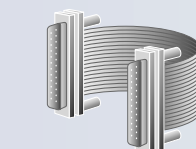

**SCSI Terminator:** Terminates the SCSI bus at the end of the chain. See Chapter 1 of the User's Guide for more information.



**SCSI Cable:** Two meter cable that connects the Autoloader to the host system. See Chapter 1 of the User's Guide for more information.

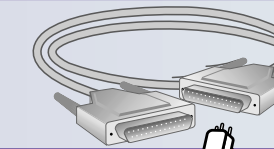

**Power Cord:** Localized power cord included with the Autoloader.

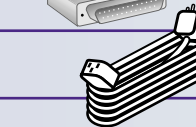

**Cleaning Tape:** Includes one cleaning tape to be used when cleaning the drive. See Chapter 2 of the User's Guide for cleaning instructions.



**Tape Cartridges:** Includes 5 tape cartridges for data backup and archiving. See Chapter 2 for loading/unloading instructions.



**User's Guide:** Describes installation, operation, troubleshooting, and service information.

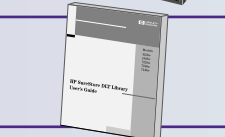

#### Additional Accessories Provided:

**Backup Software:** Contains several versions of live trial backup software. See the CD-ROM for installation and configuration instructions.

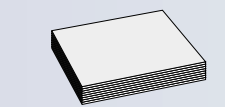

**HP SureStore Tape CD:** Includes diagnostic utilities, backup software information, and localized versions of the User's Guide.



**SCSI Bus Adapter:** Install into the host system. See the SCSI Bus Adapter User's Guide for installation and configuration instructions, as well as Chapter 1 of the User's Guide.

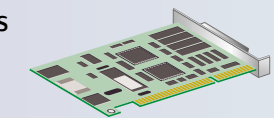

Standard Setup Instructions

Rack Mount Setup Instructions

Hints To Get You Running